

System Windura E Top

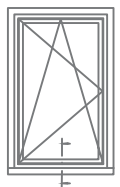

windura-E top
16.12.2019 ham
© Ernst Schweizer AG
4/37 381-101

Schnitt unten, Festverglasung mit Glasleiste
 Coupe inférieure, vitrage fixe avec liste à verre

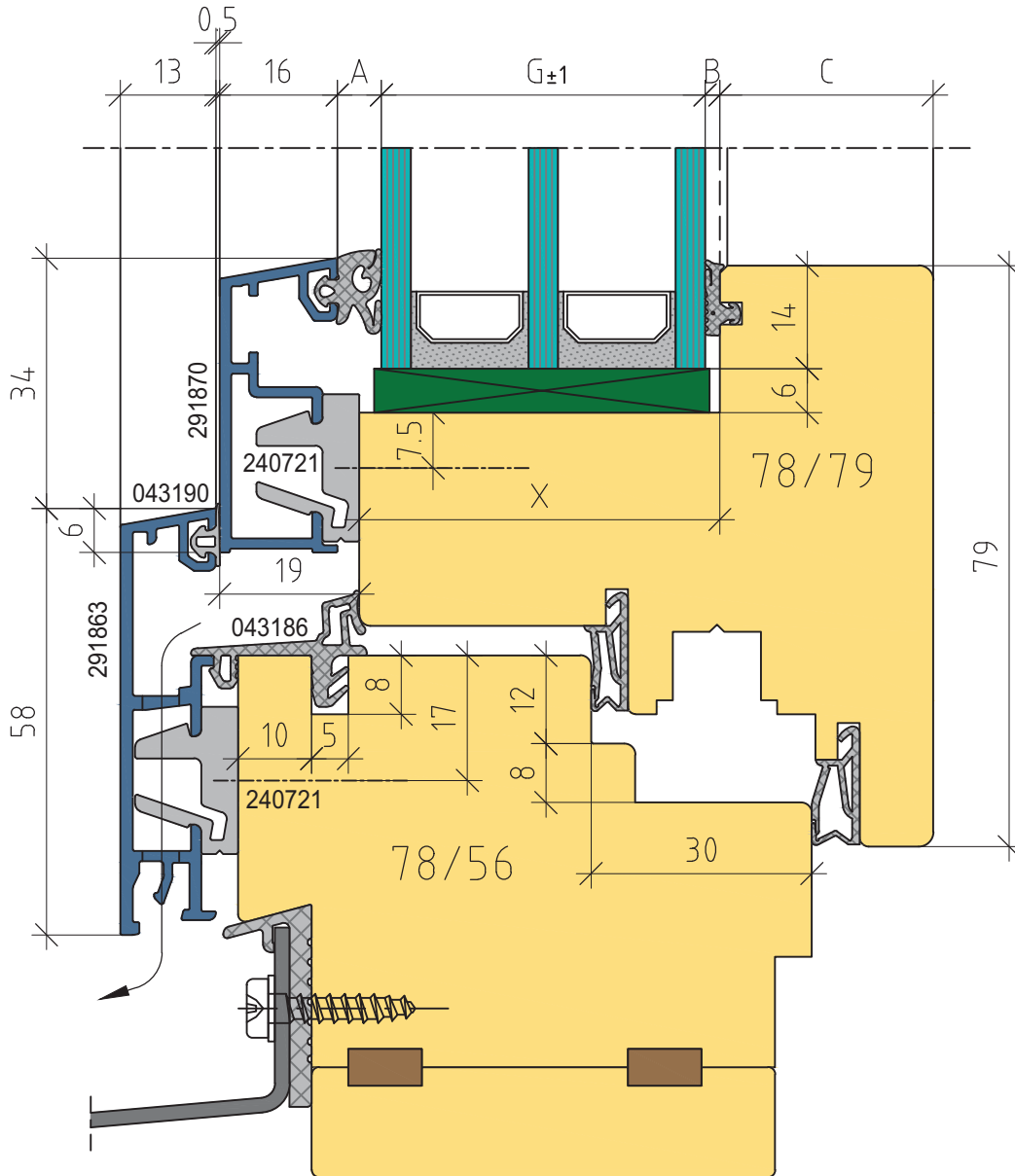
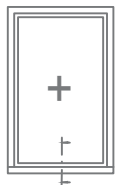
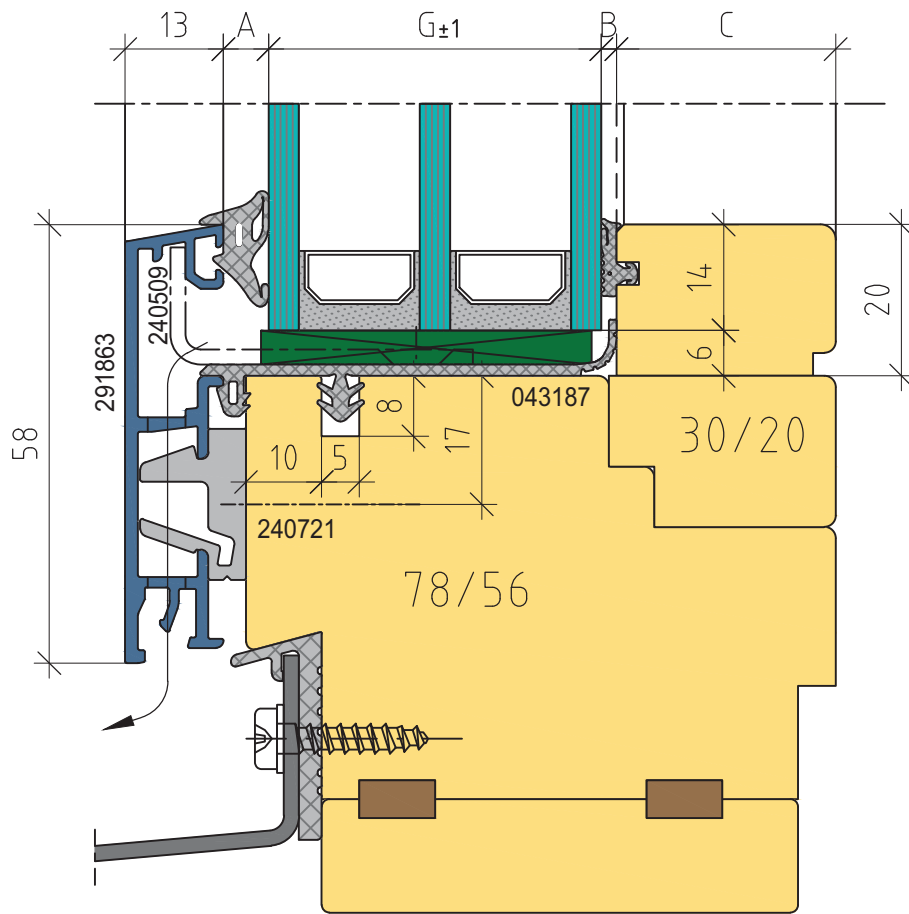

Schnitt unten, Festverglasung von aussen
 Coupe inférieure, vitrage fixe de l'extérieur

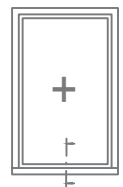
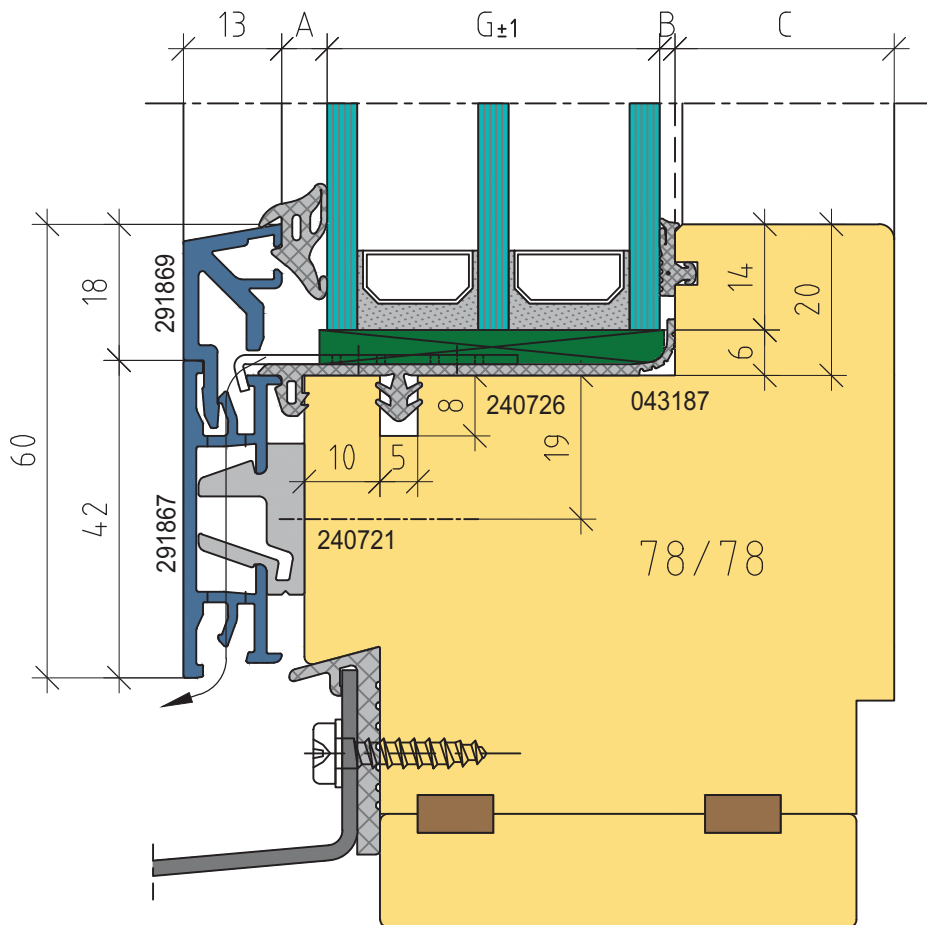

Schnitt oben mit Rahmenverbreiterung Coupe supérieur avec élargissement de cadre

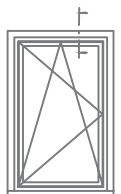
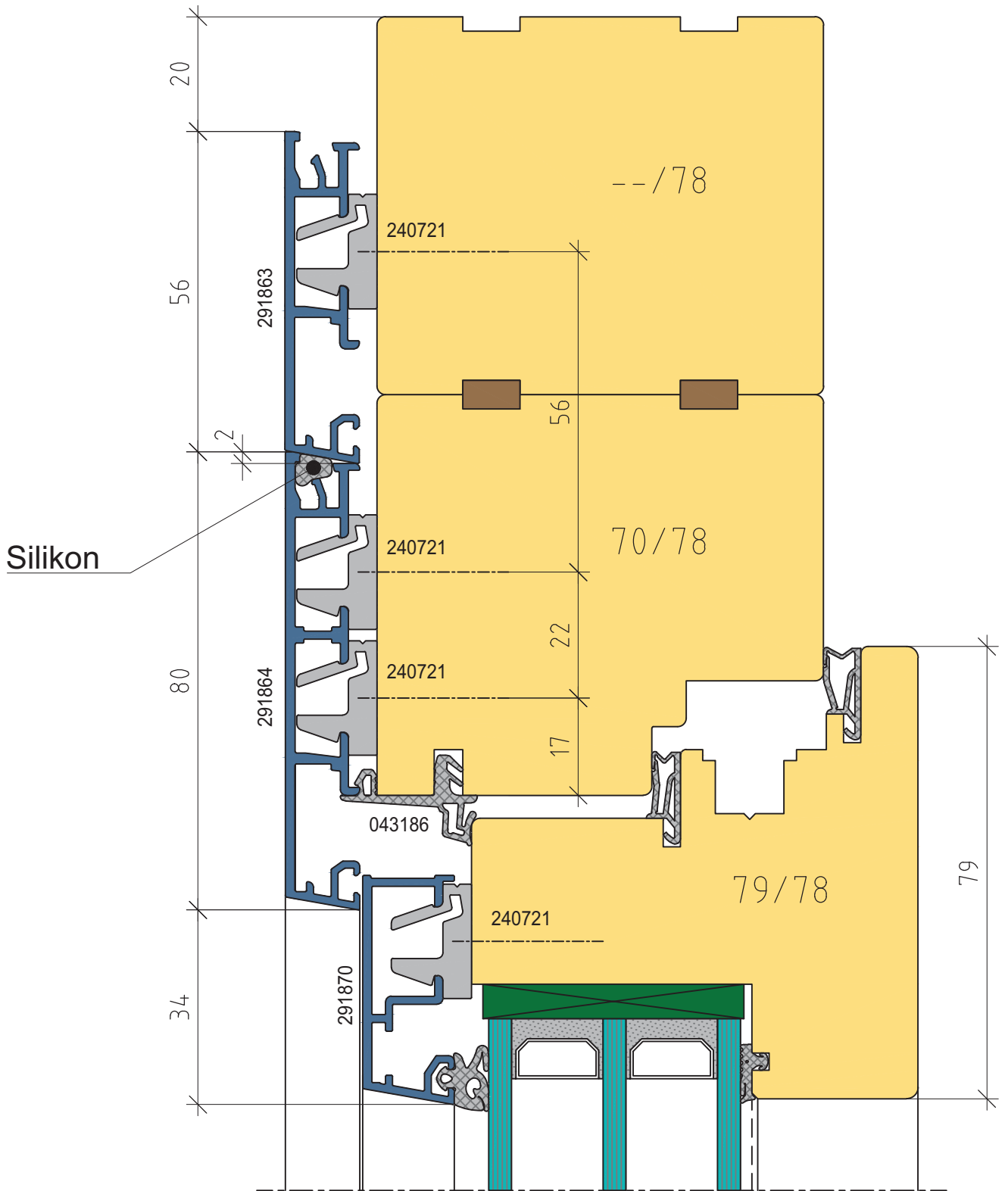

Schnitt seitlich, Flügel flächenversetzt
 Coupe latérale, ouvrant décalé

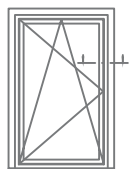
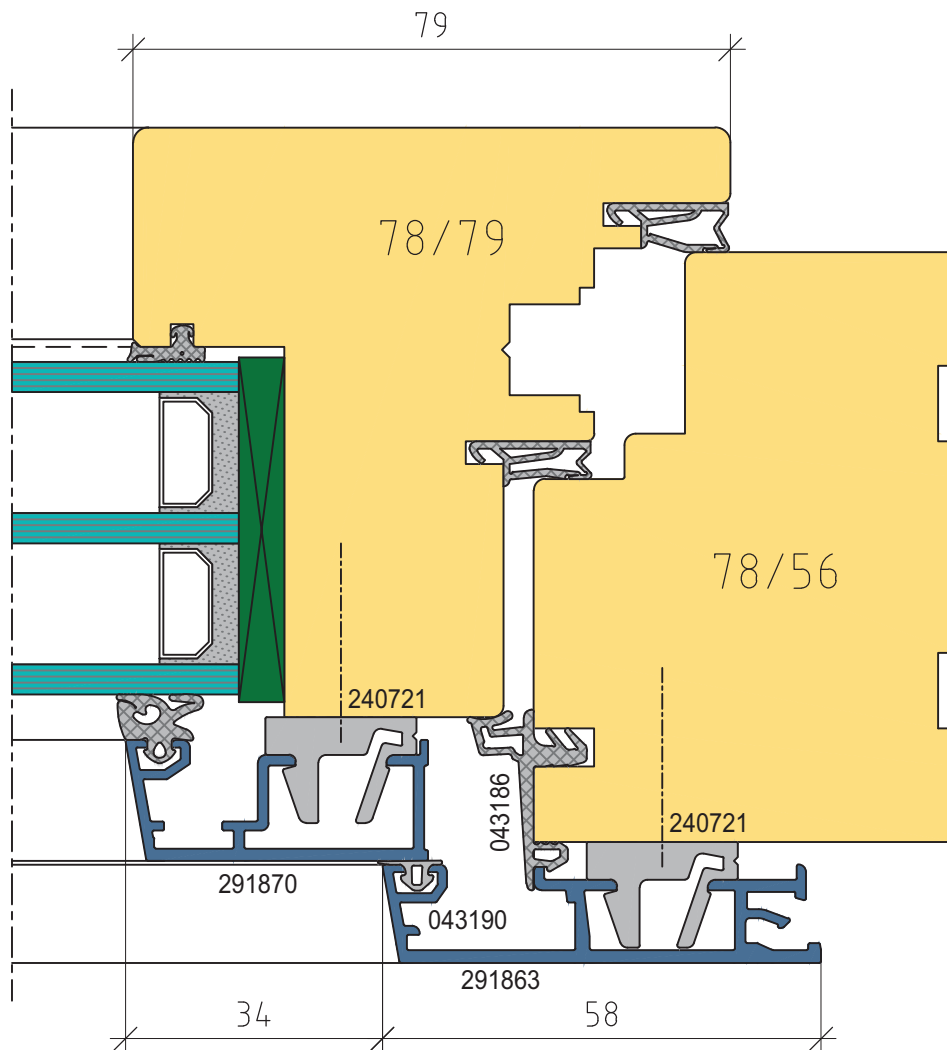

Schnitt seitlich, Festverglasung mit Glasleiste Coupe latérale, vitrage fixe avec liste à verre

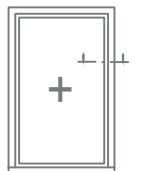
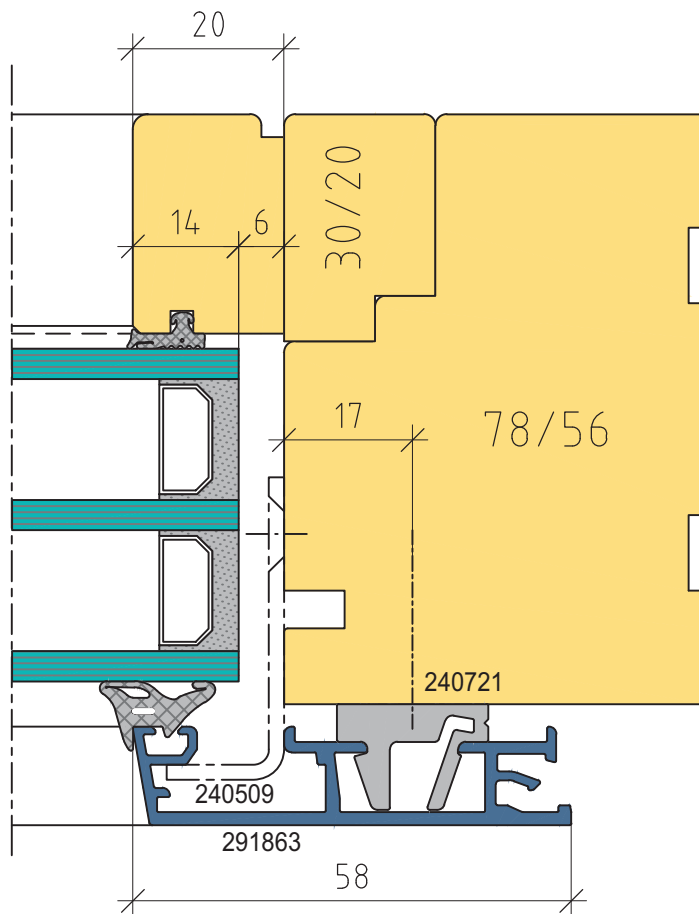

Schnitt seitlich, Festverglasung von aussen
 Coupe latérale, vitrage fixe de l'extérieur

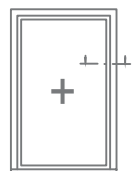
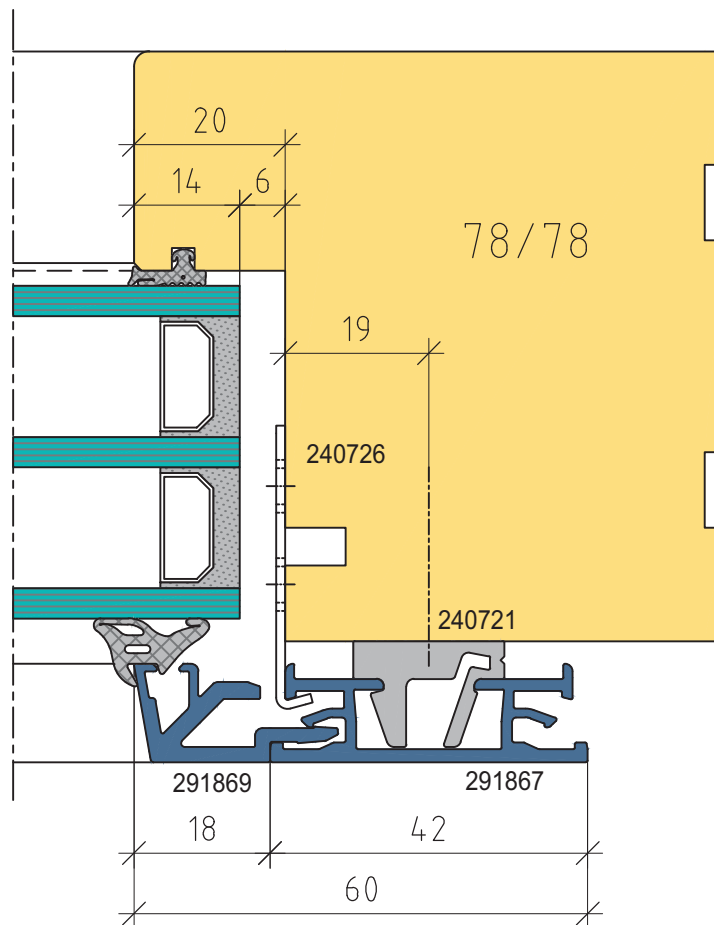

Rahmensprosse 78 mm, Festverglasung von aussen
 Montant 78 mm, vitrage fixe de l'extérieur

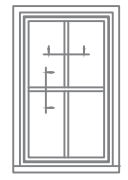
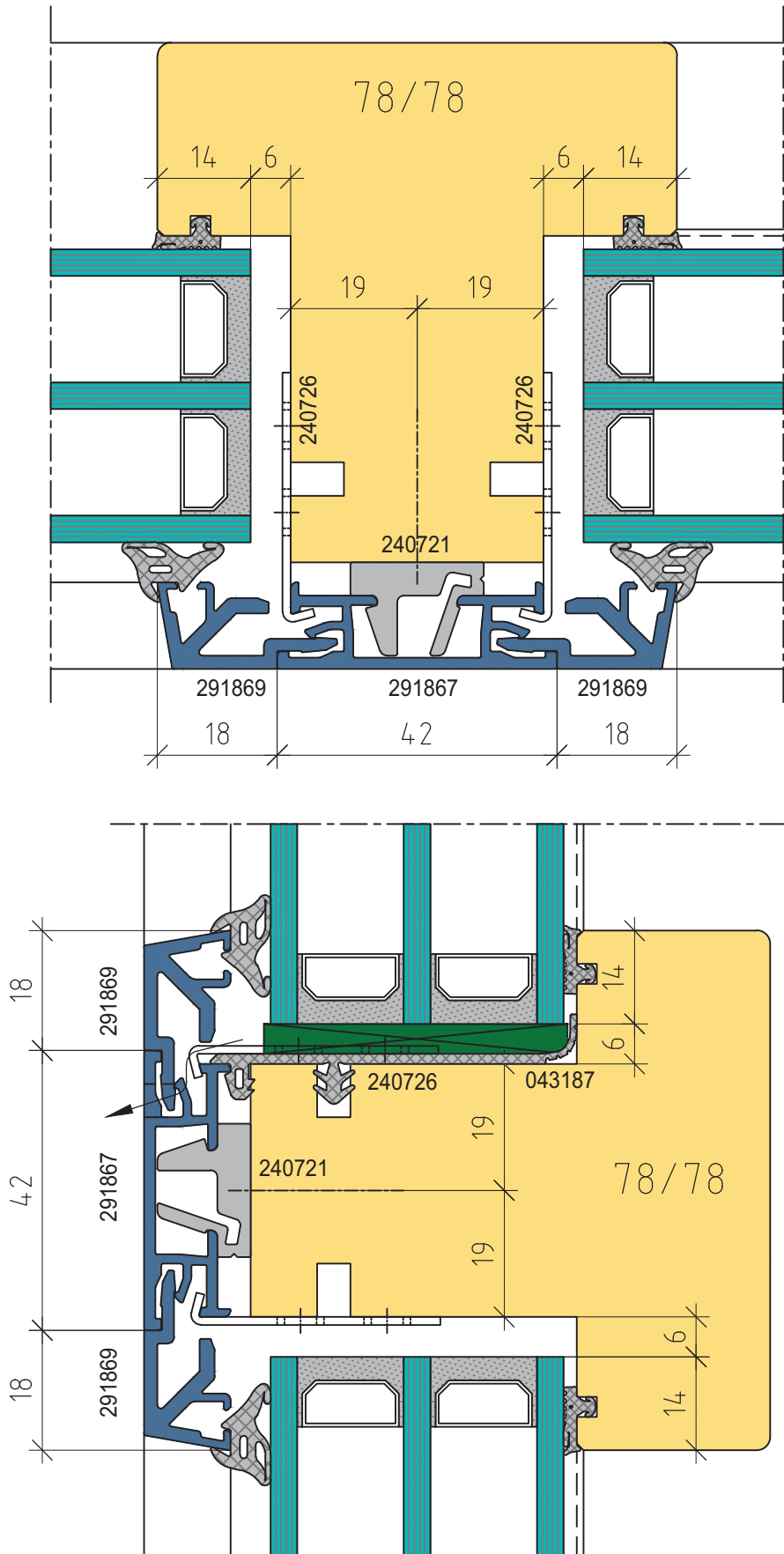

Ziersprosse 18 mm
Croisillon 18 mm

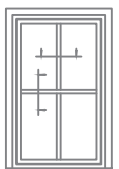
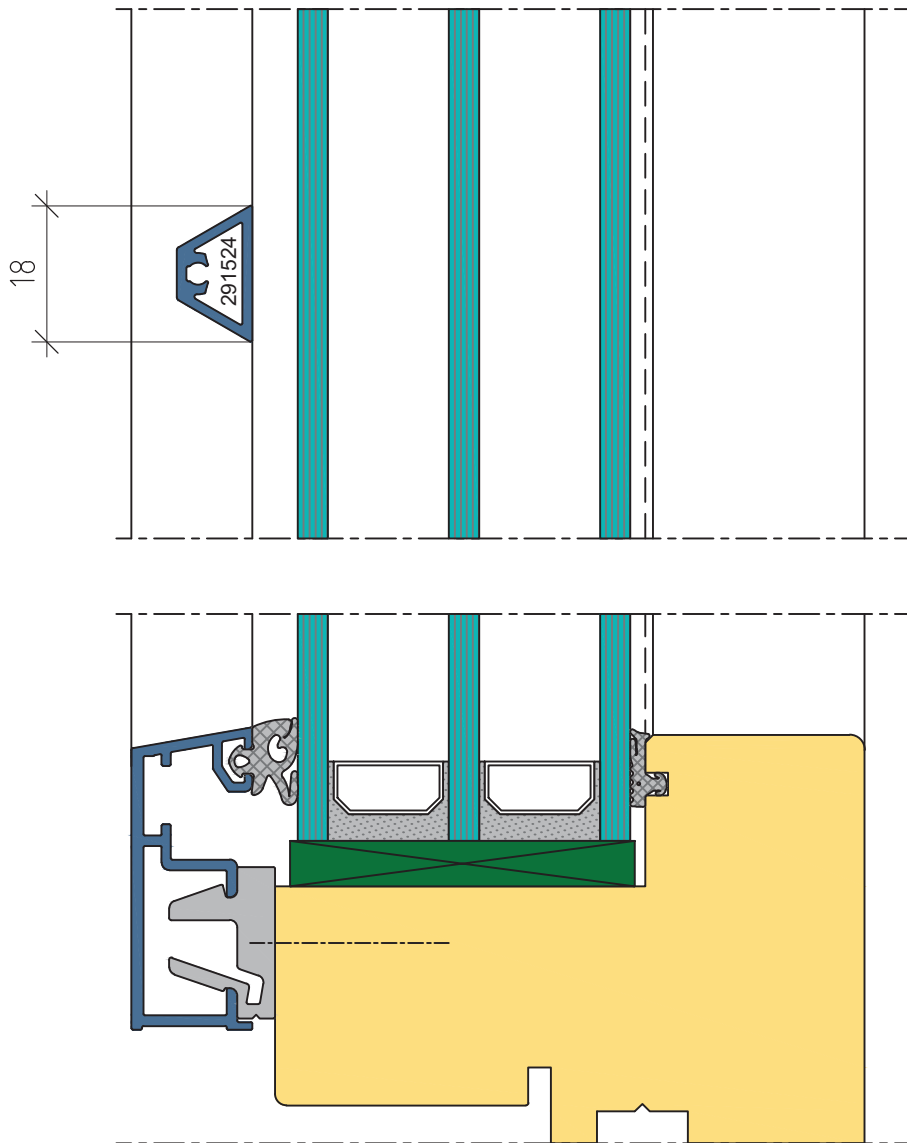

Ziersprosse 25 mm
Croisillon 25 mm

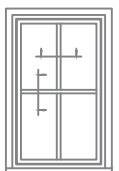
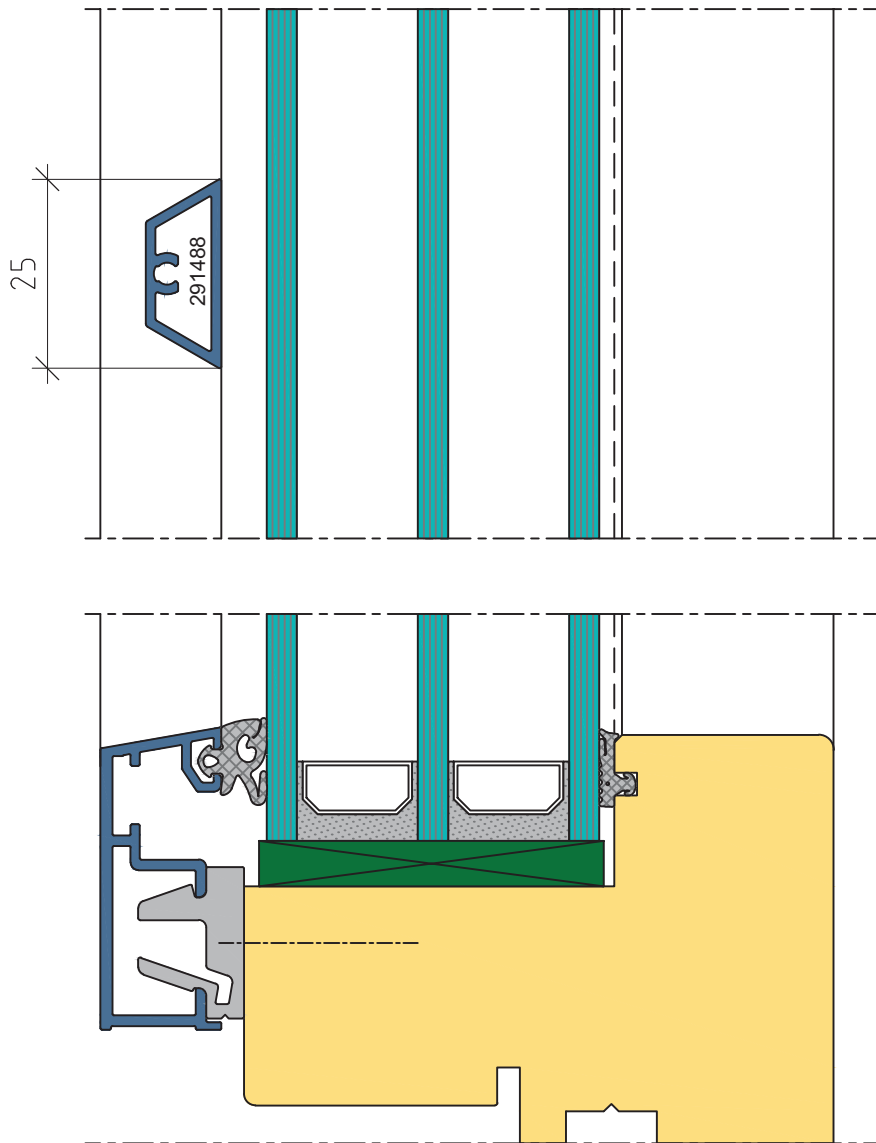

Mittelpartie 132 mm, Flügel flächenversetzt
 Partie médiane 132 mm, ouvrant décalé

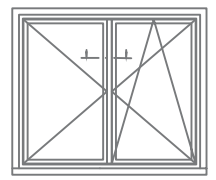
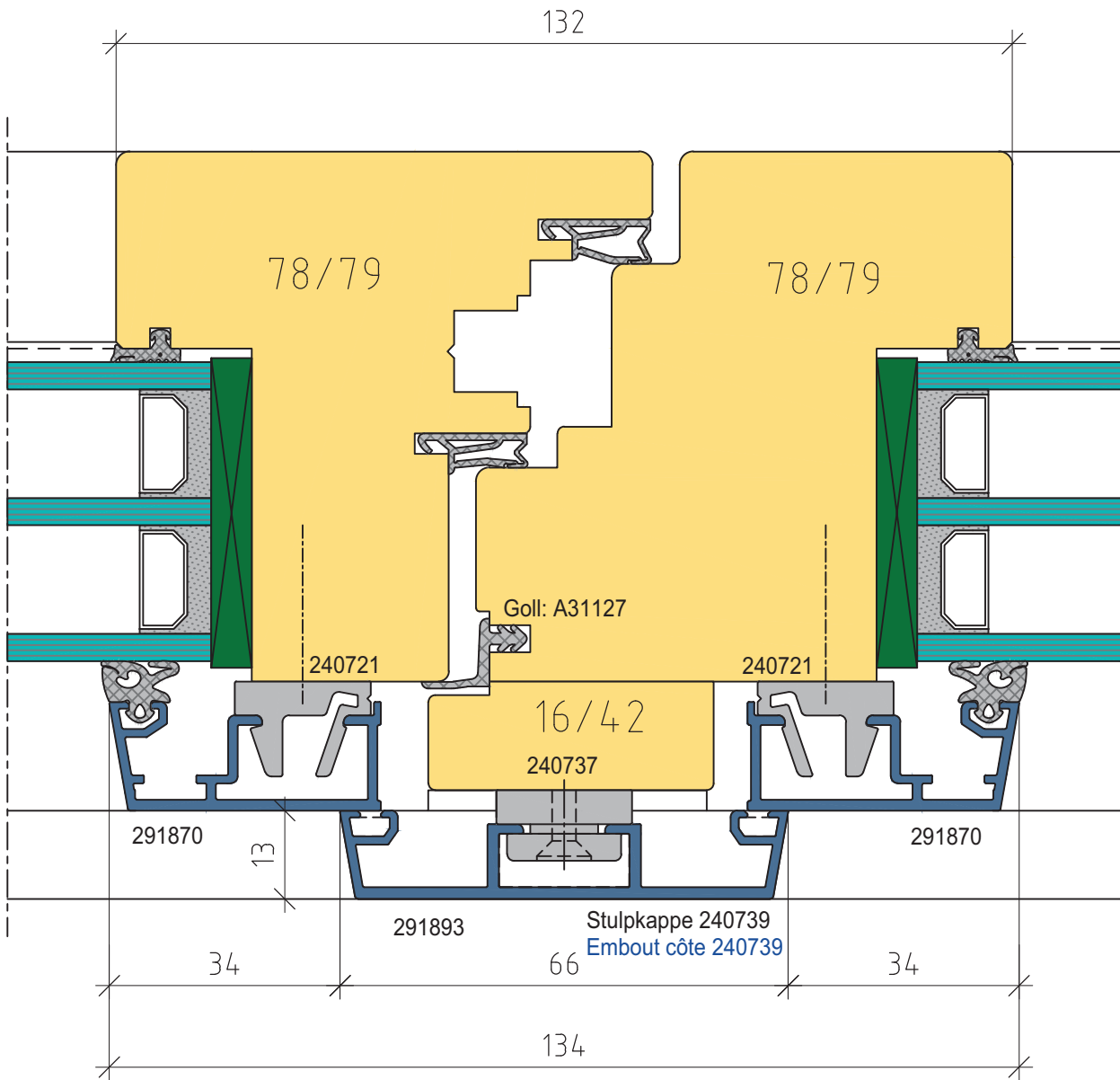

Setzpfosten 70/110 mm
 Montant 70/110 mm

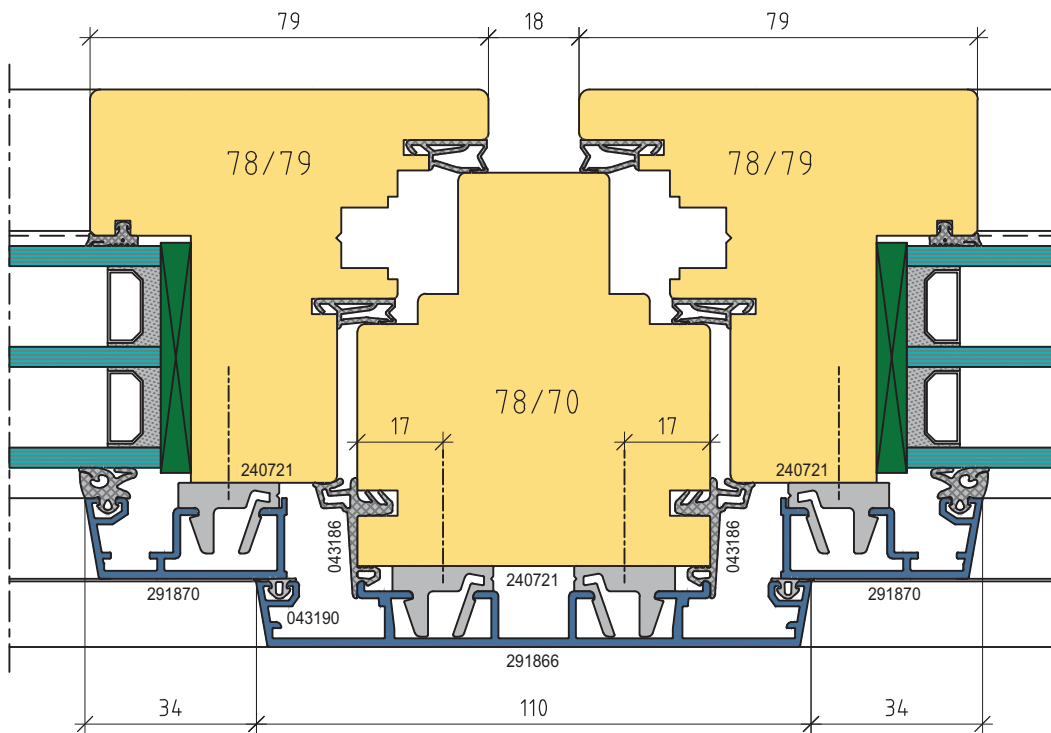

Masstab
 1 : 1.5

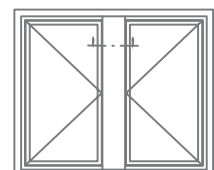

Setzposten 92/132 mm

Montant 92/132 mm

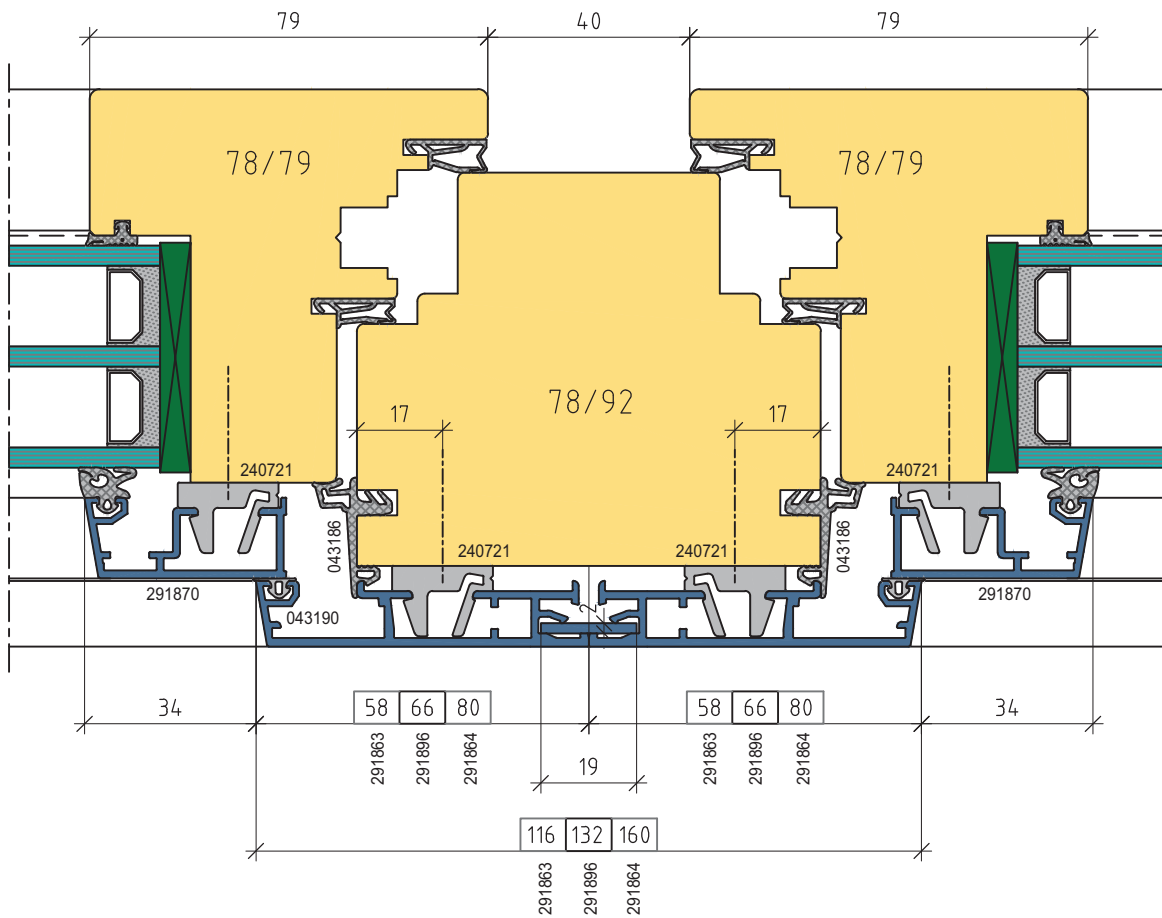

Masstab
1 : 1.5

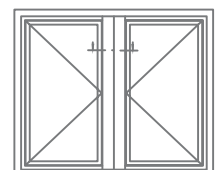

Setzposten variabel Montant variable

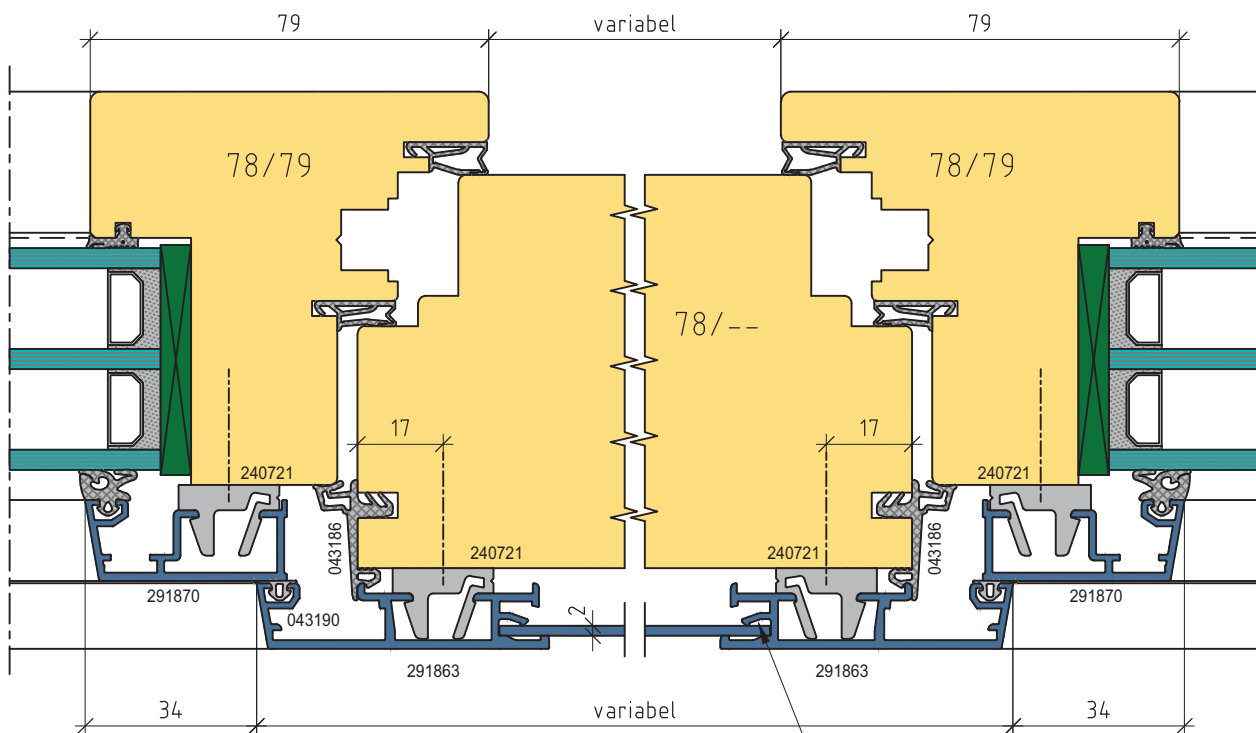

Kopplungsblech gegen
das Abrutschen sichern
Sécuriser la tôle de liaison
contre le glissement

Masstab
1 : 1.5

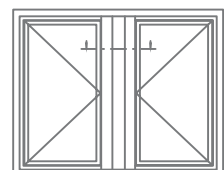

Setzposten mit statischer Verstärkung

Montant avec renforcement statique

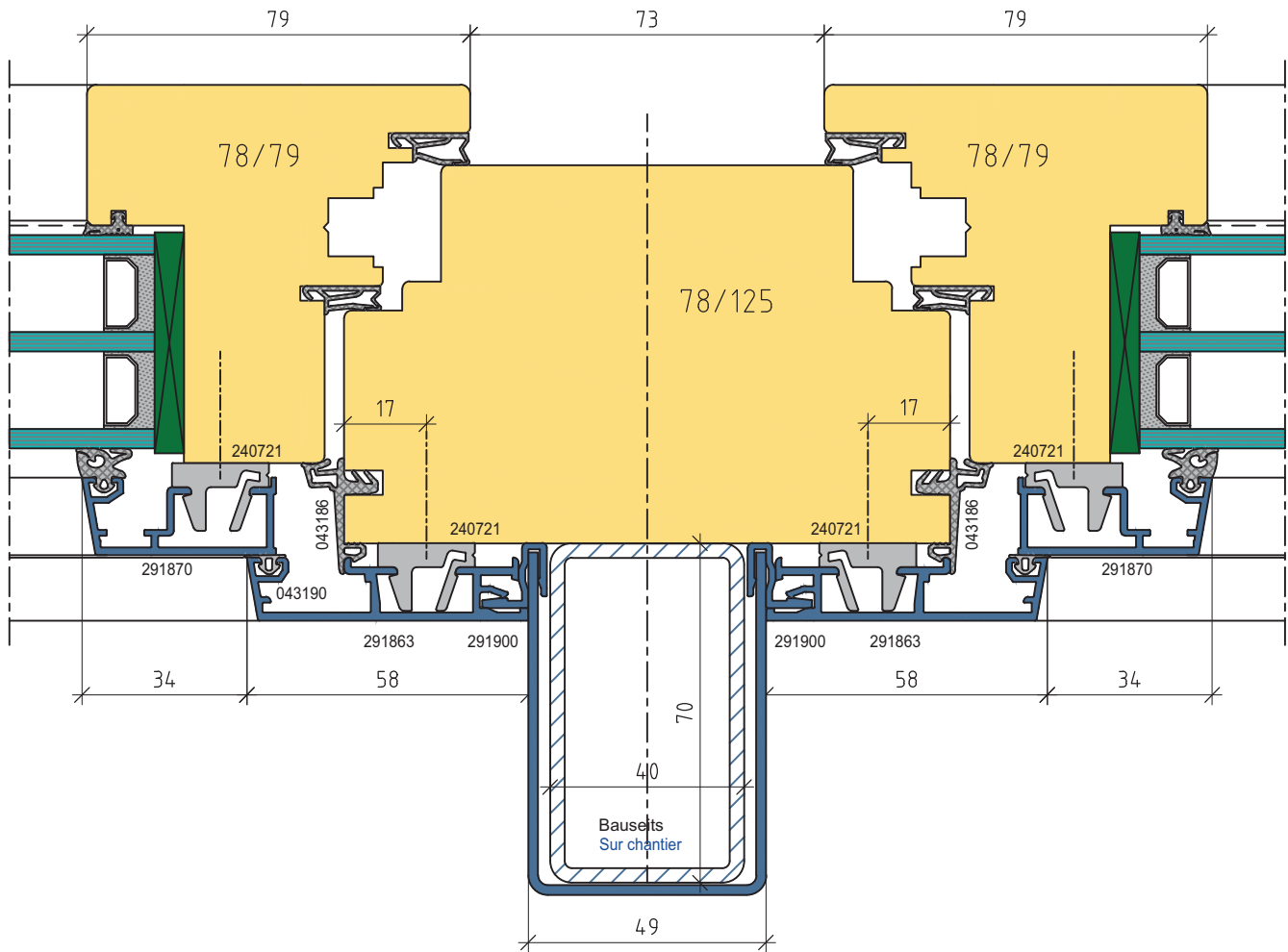

Masstab
1 : 1.5

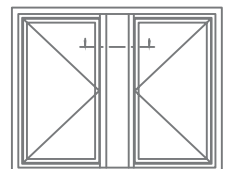

Kämpfer 70/110 mm mit Oberlicht
 Traverse 70/110 mm avec vasistas

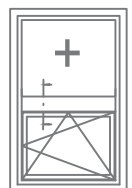
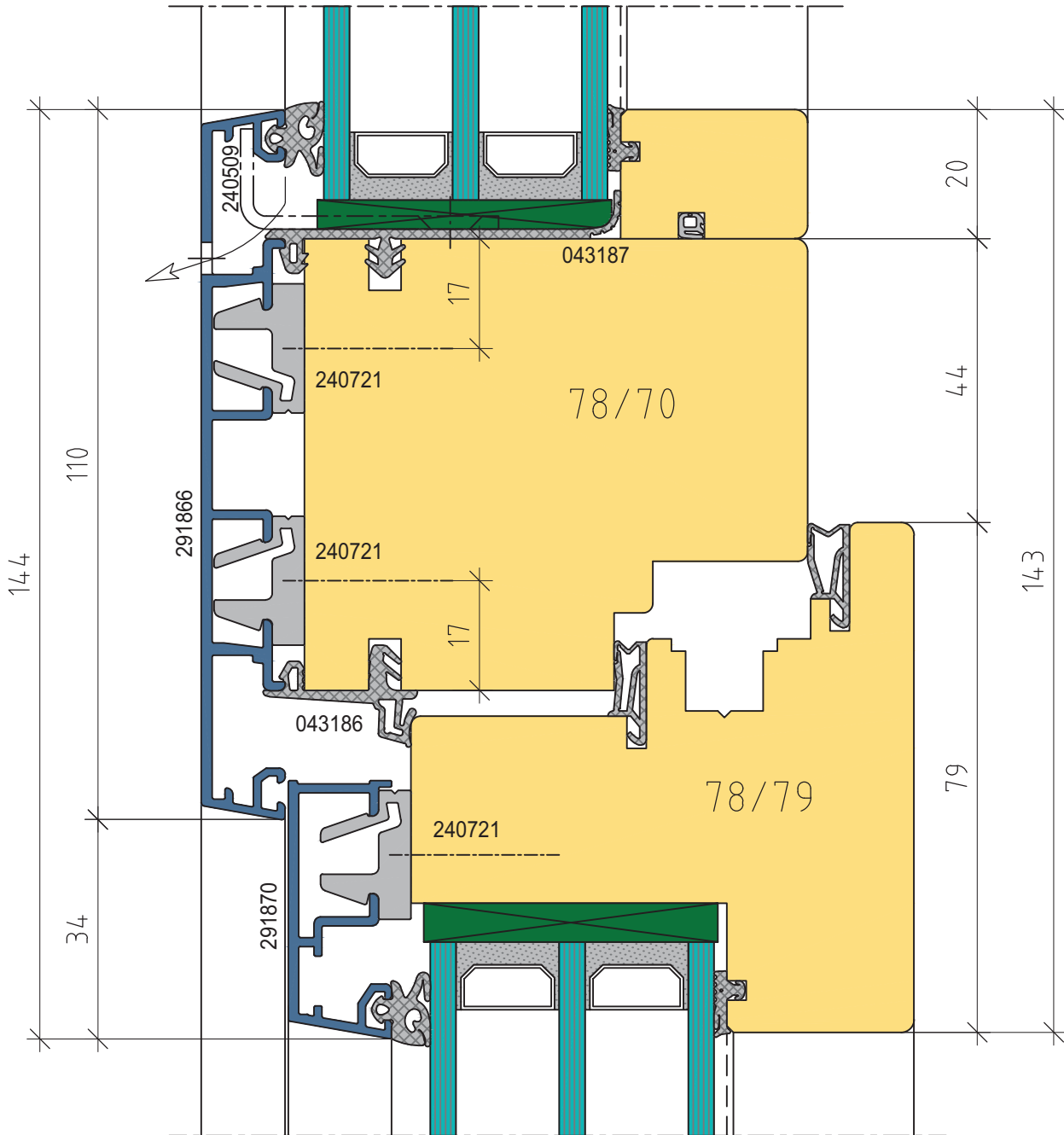

Kämpfer 70/110 mm mit Unterlicht
 Traverse 70/110 mm avec sous-éclairé

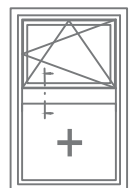
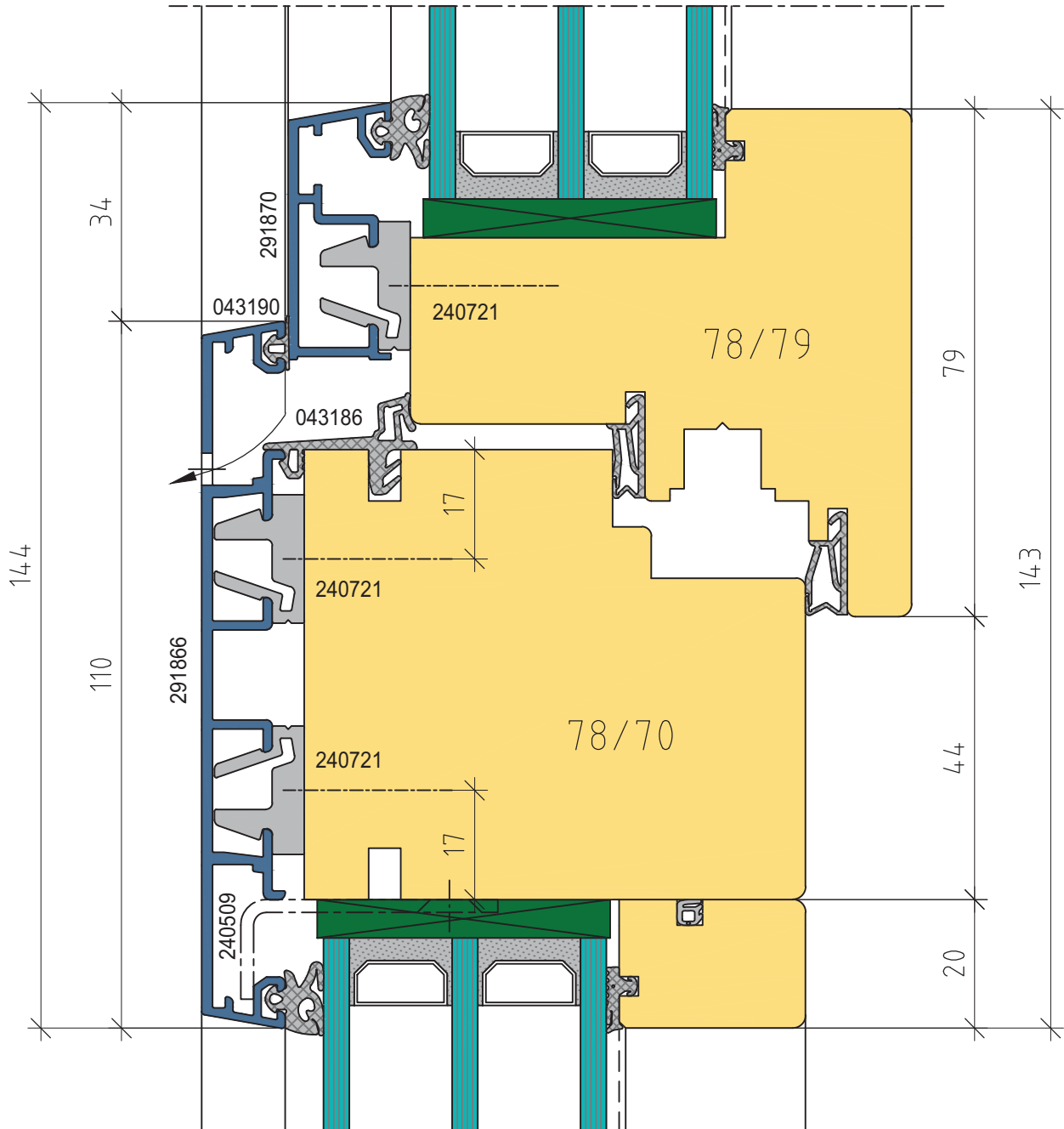

Elementkopplung, Festverglasung von aussen - Flügel Jonction d'élément, vitrage fixe de l'extérieur - ouvrant

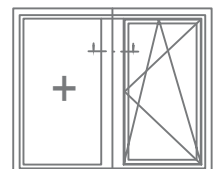
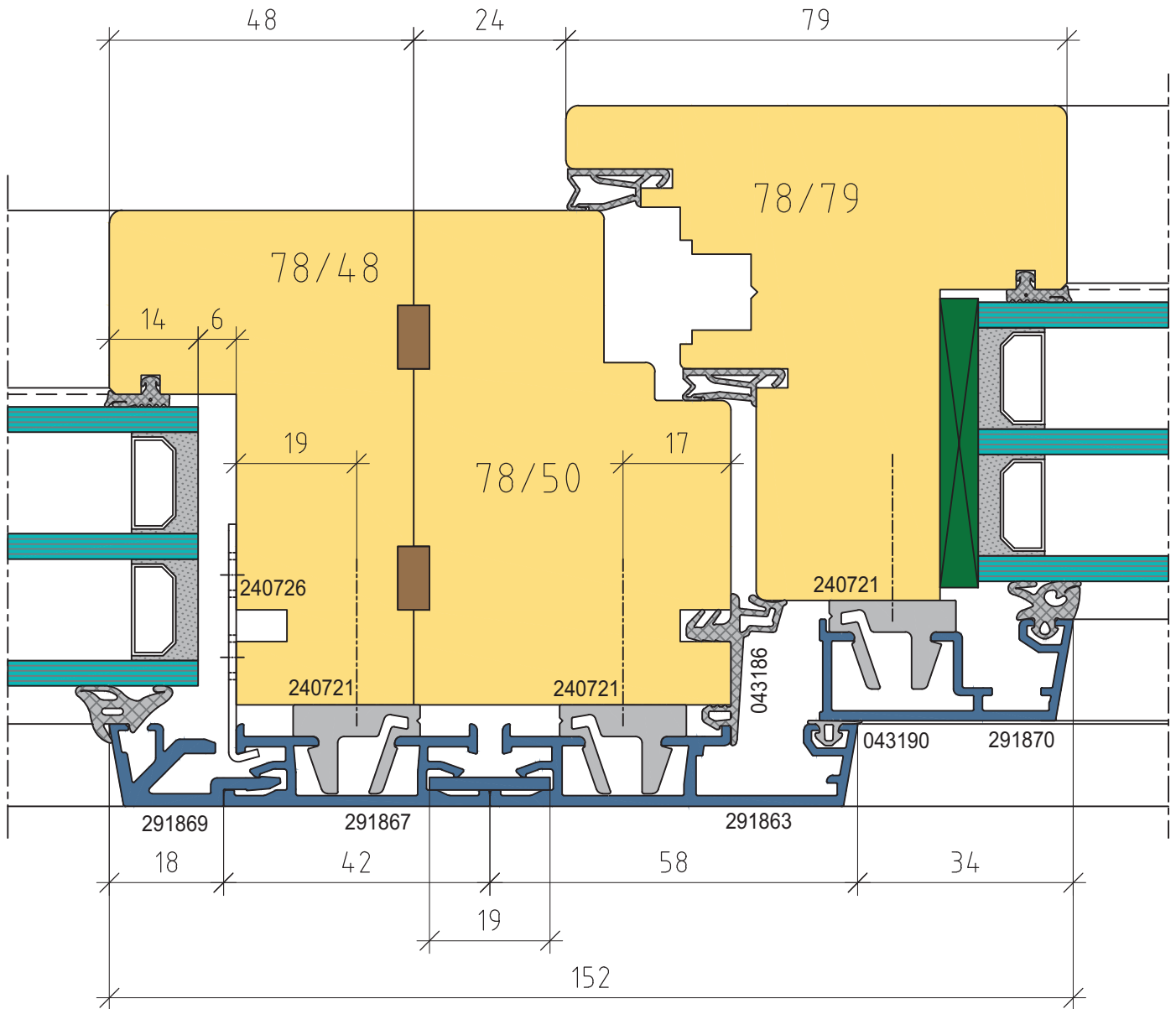

Elementkopplung mit statischer Verstärkung

Jonction d'élément avec renforcement statique

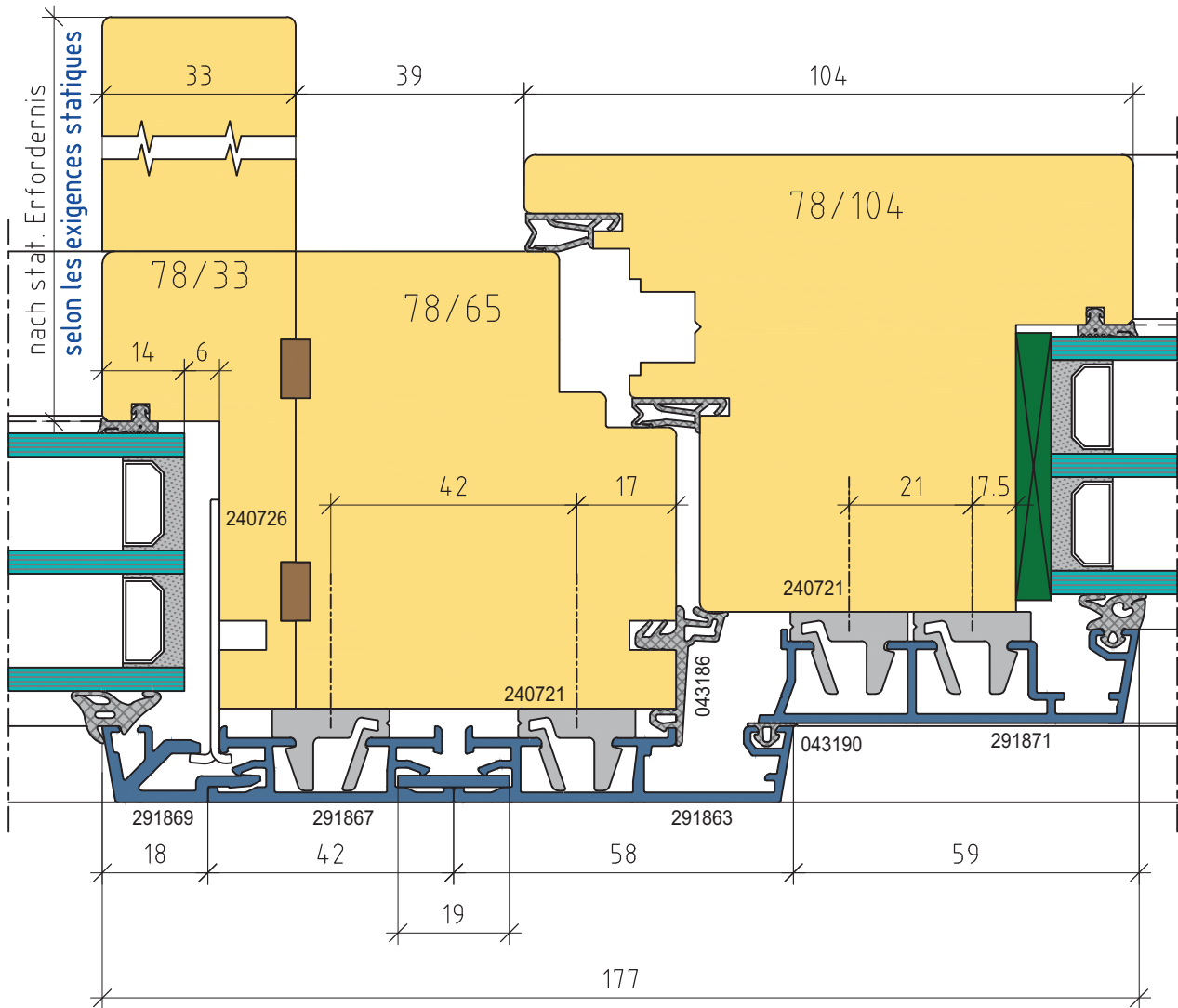

Masstab
1 : 1.2

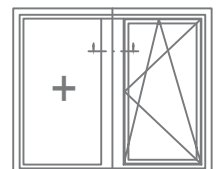

windura-E top
16.12.2019 ham
© Ernst Schweizer AG
4/37 381-802

Elementkopplung vertikal, Festverglasung von aussen - Flügel Jonction d'élément verticale, vitrage fixe de l'extérieur - ouvrant

gauche+droite à l'extér.
étancher au silicone
links + rechts aussen
mit Silikon abdichten

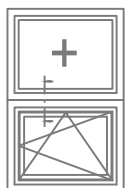
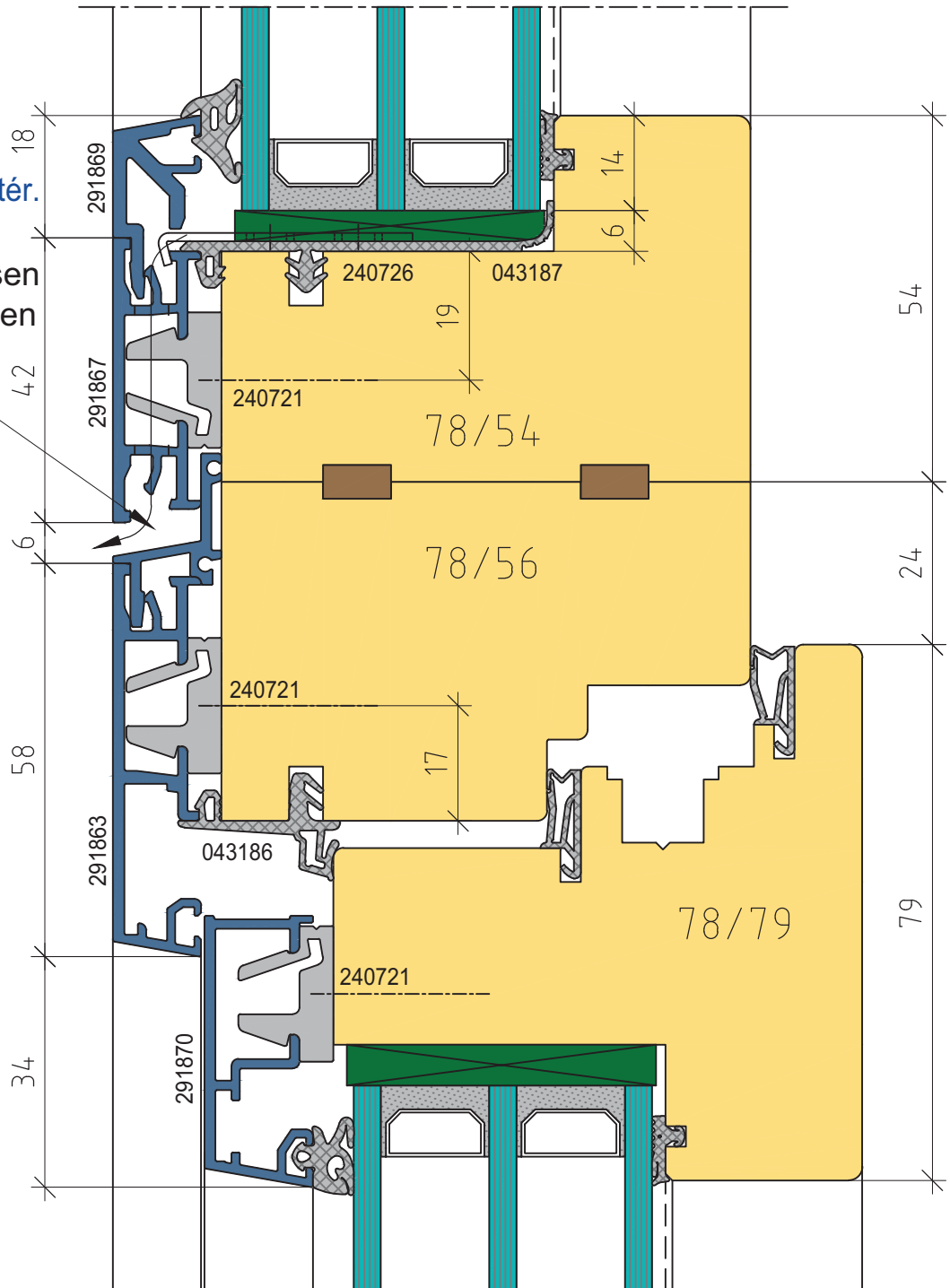

Elementkopplung Aussenecke, Festverglasung von aussen - Flügel Jonction d'élément angle extérieur, vitrage fixe de l'ext. - ouvrant

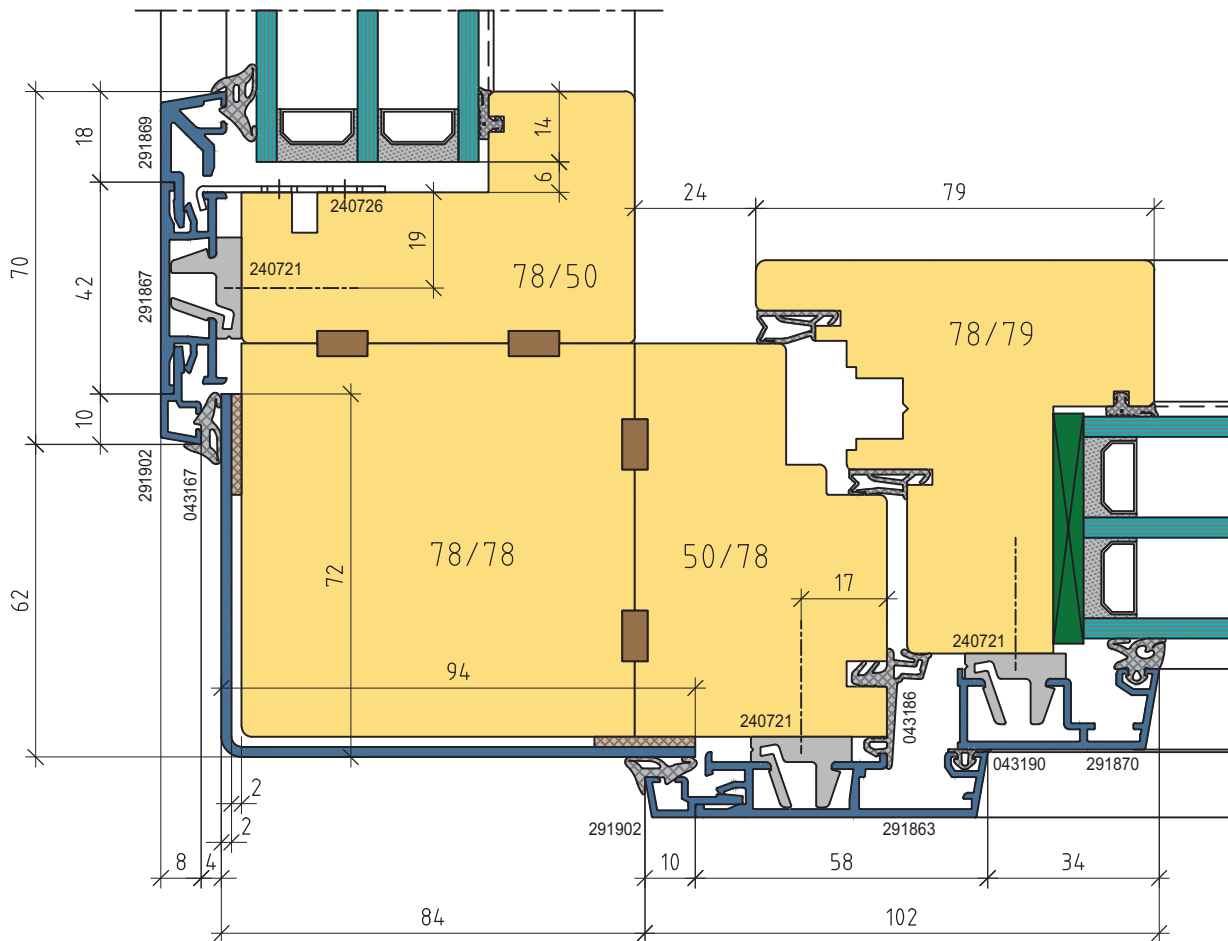

Masstab
1 : 1.5

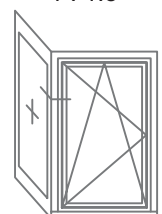

Elementkopplung Innenecke, Festverglasung von aussen - Flügel Jonction d'élément angle intérieur, vitrage fixe de l'ext. - ouvrant

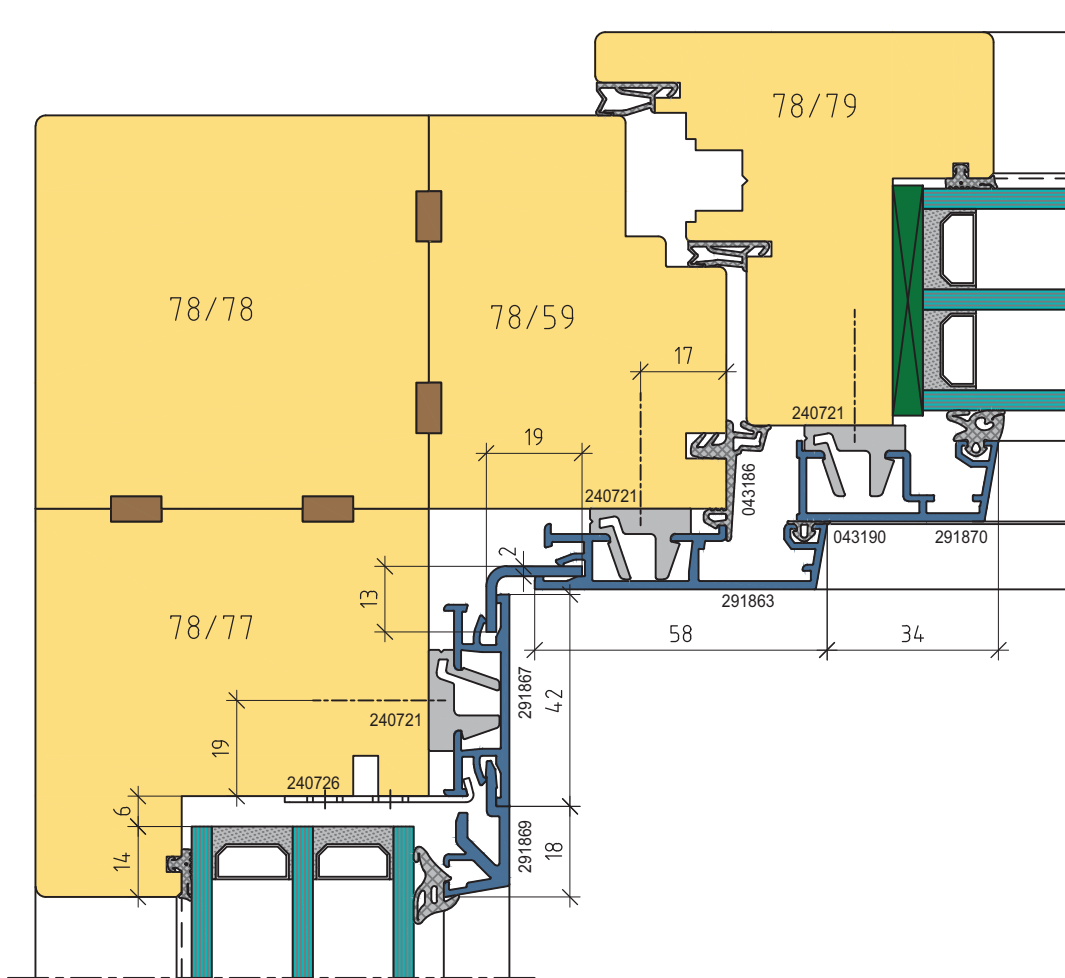

Masstab
1 : 1.5



windura-E top
16.12.2019 ham
© Ernst Schweizer AG
4/37 381-805

Steinbankanschluss unten, Entwässerung direkt
 Rebord de fenêtre, évacuation d'eau direct

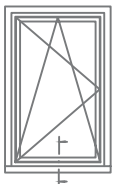
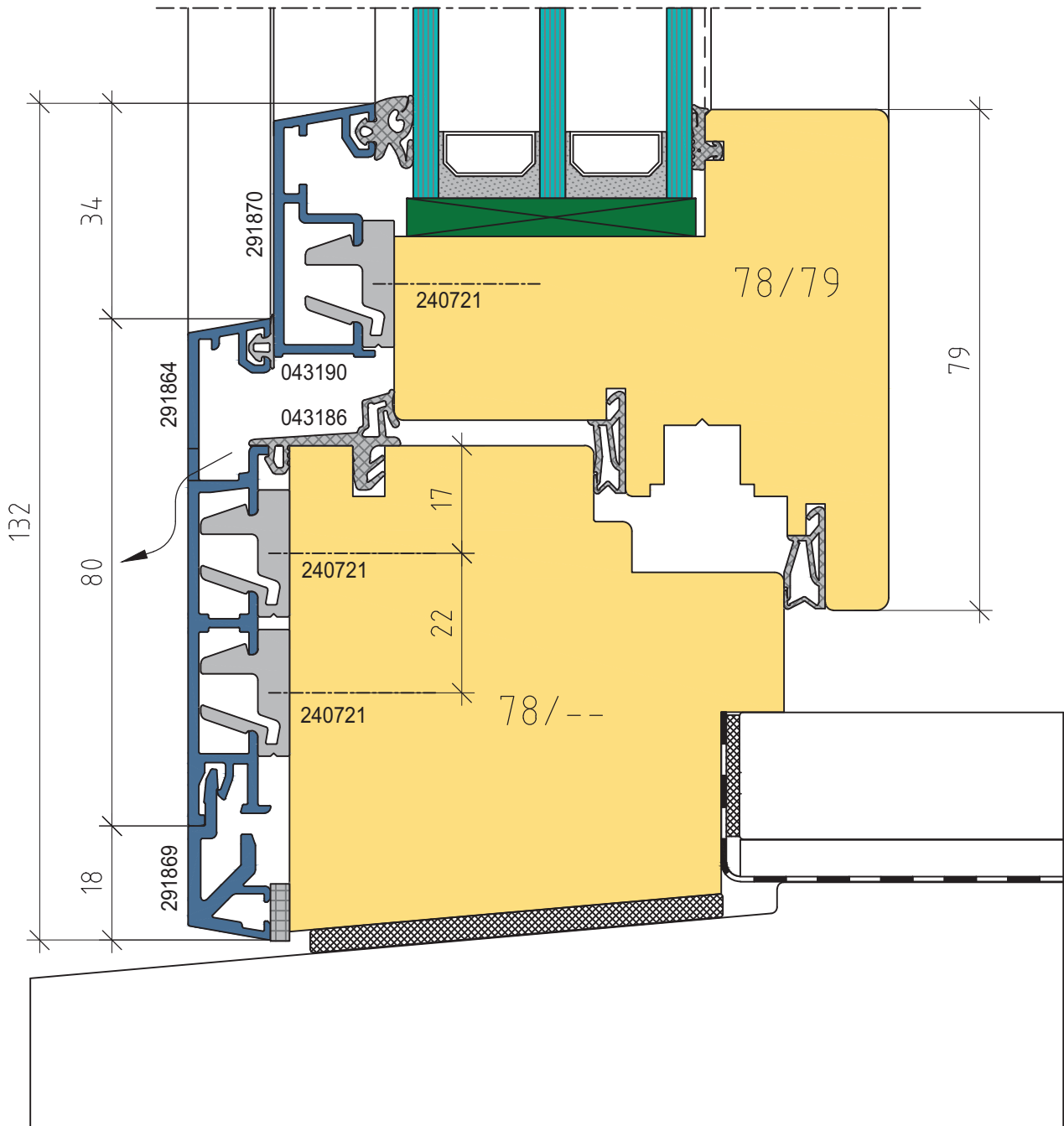

Steinbankanschluss unten, Entwässerung indirekt
 Rebord de fenêtre, évacuation d'eau indirect

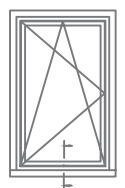
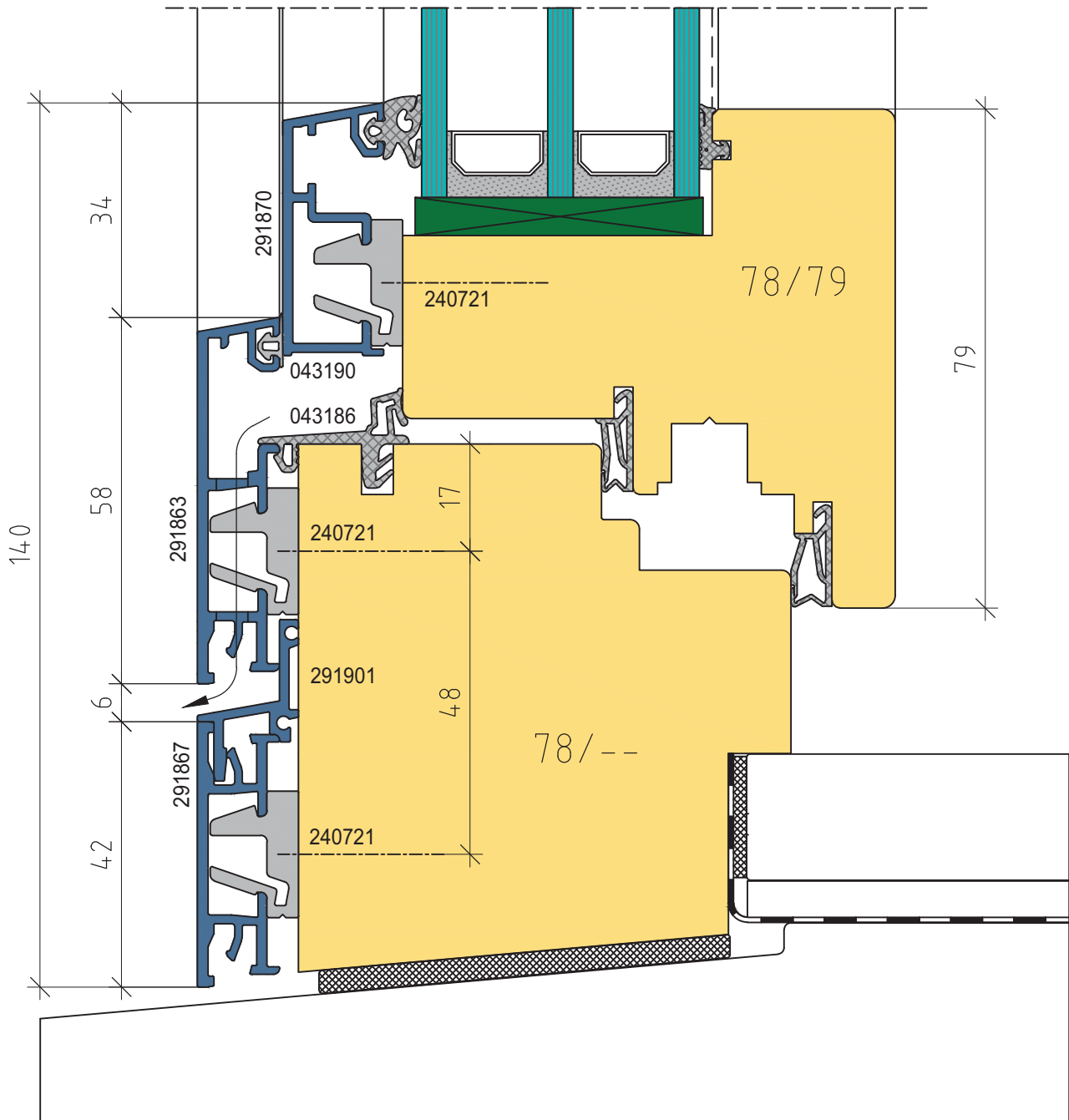

Nullschwelle, Durchgang Seuil zéro, passage

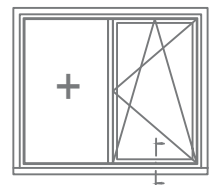
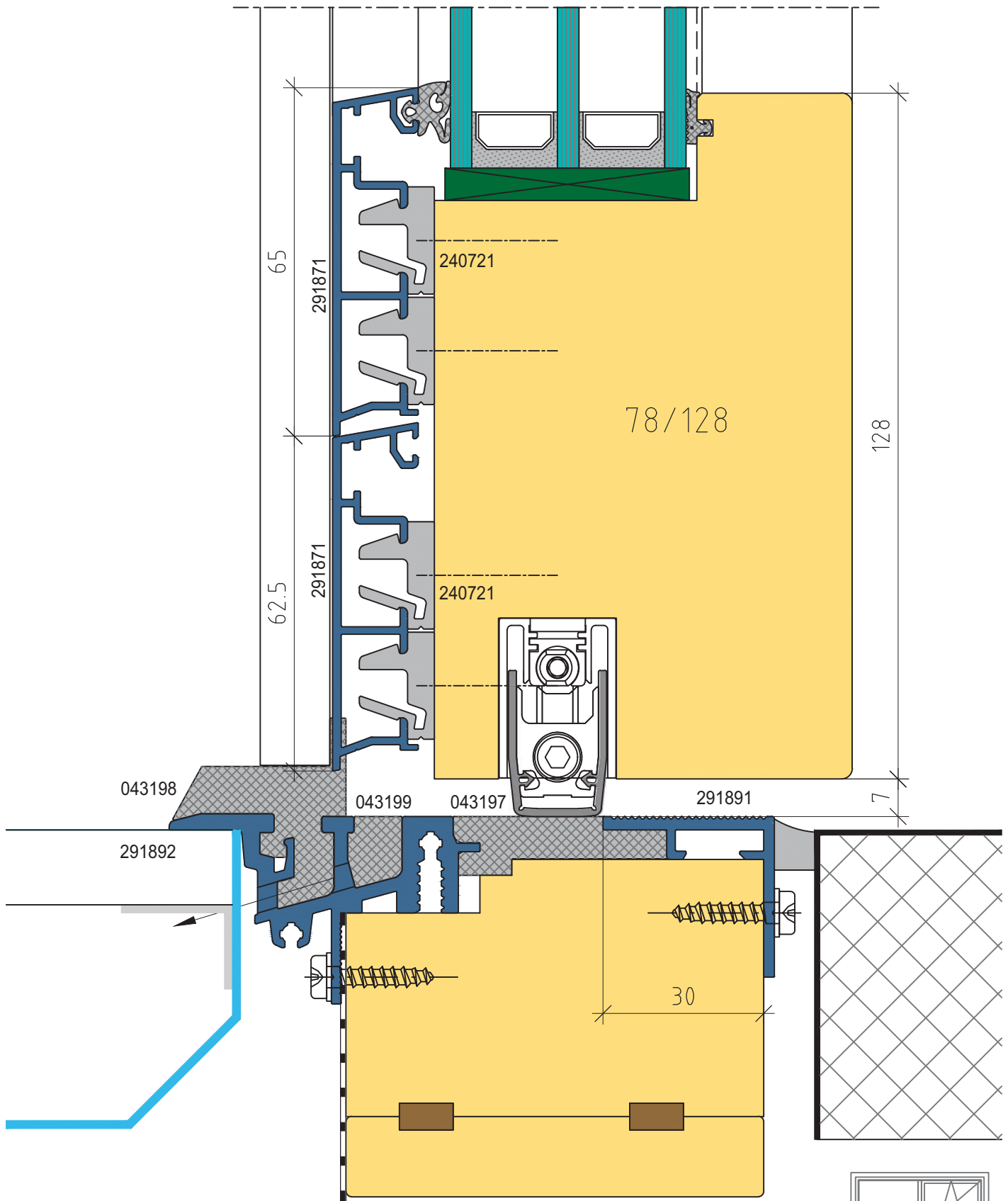

windura-E top
27.08.2019 ham
© Ernst Schweizer AG
4/37 382-101

Nullschwelle, Festverglasung von aussen
 Seuil zéro, partie fixe vitrée de l'extérieur

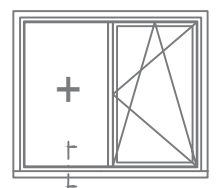
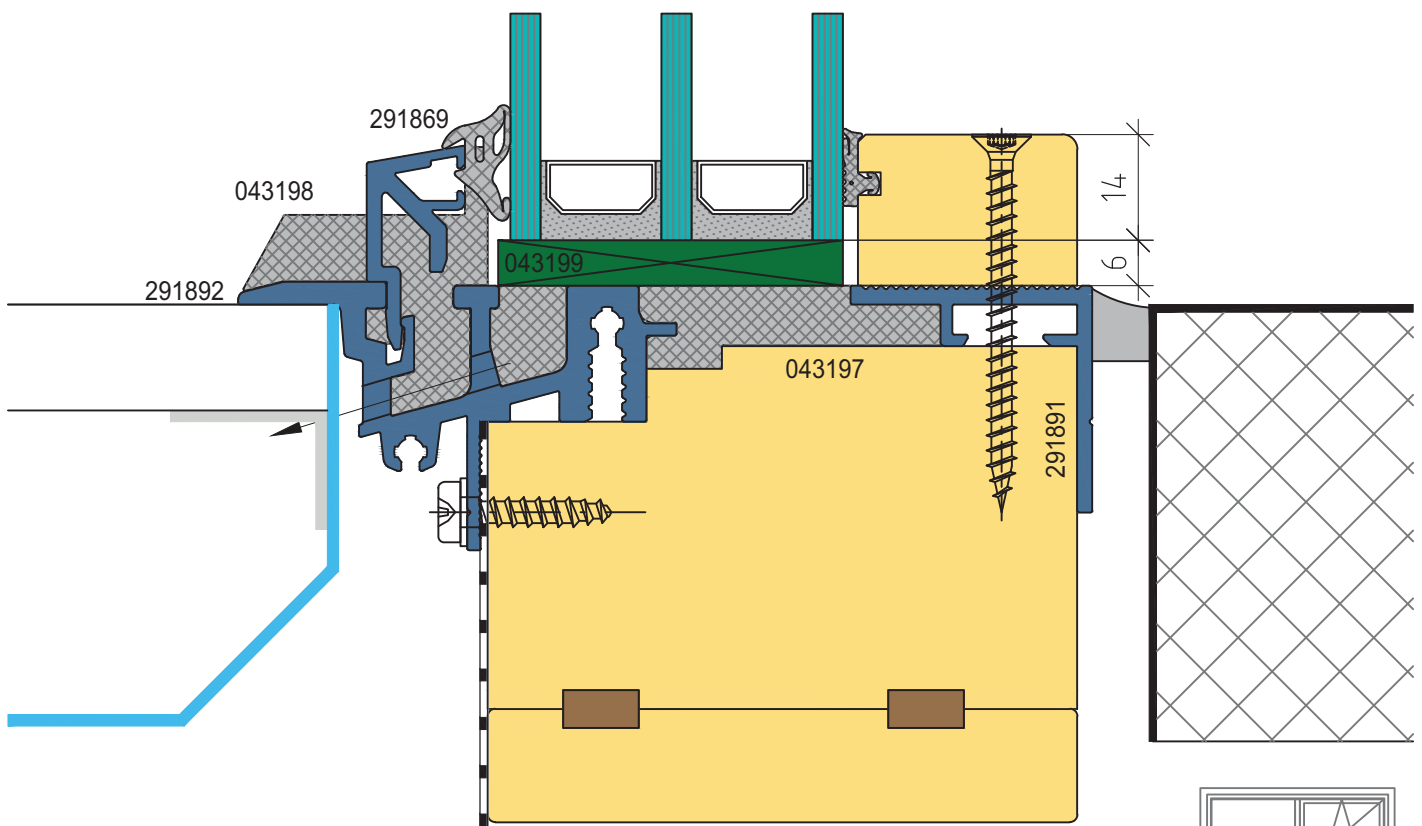

windura-E top
 16.12.2019 ham
 © Ernst Schweizer AG
 4/37 382-181

Schnitt seitlich, durchgehender Griff
 Coupe latérale, poignée traversante

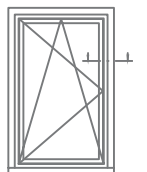
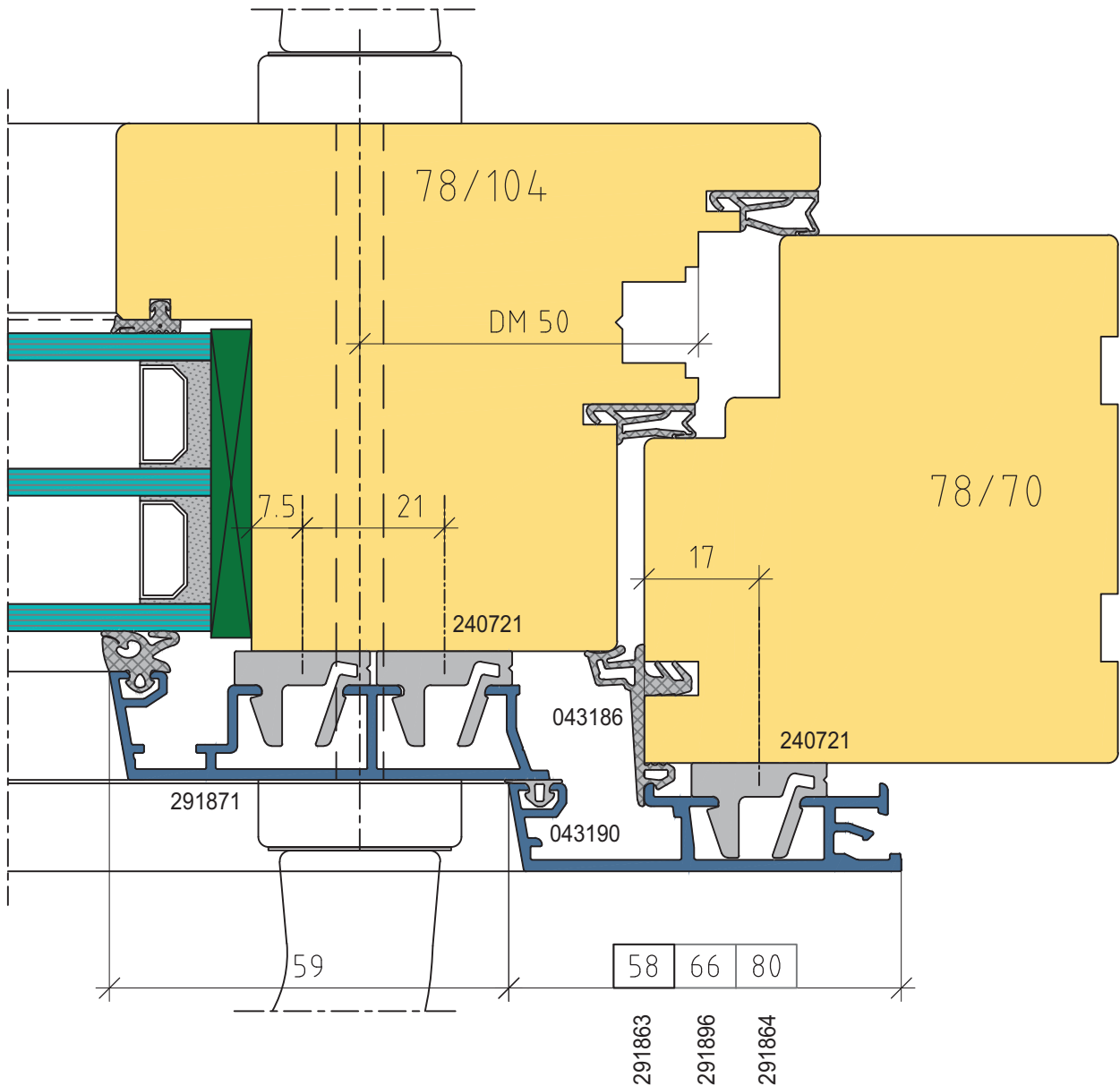

Aluminium Profilübersicht, schräg Gamme de profilés aluminium, en biais

M 1:2

Rahmenprofile Dormants

291863

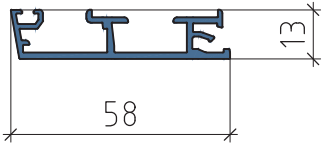

291896

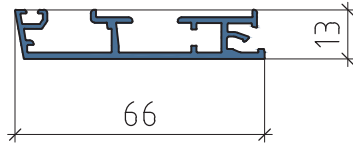

291864

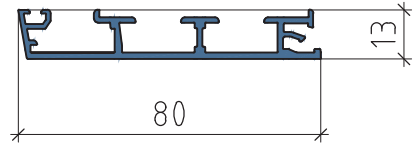

Spinnenprofile Montants

291866

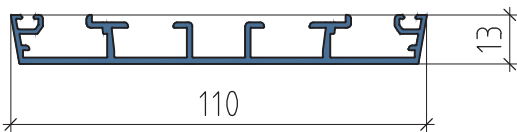

Integralrahmen Dormants, intégral

291865

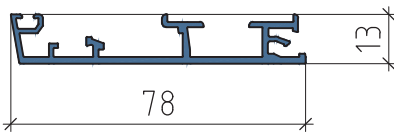

Flügel, Flächenversetzt Ouvrant, décalé

291871

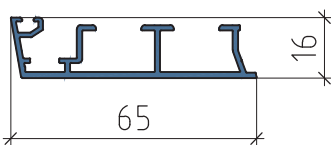

291870

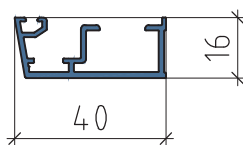

Flügel, Flächenbündig Ouvrant, affleuré

291872

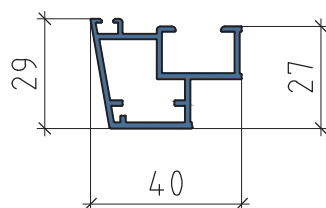

Aluminium Profilübersicht, schräg Gamme de profilés aluminium, en biais

M 1:2

Rahmenprofile, Aussenverglast
Dormants, vitrage fixe extérieur

291867

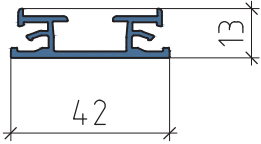

291868

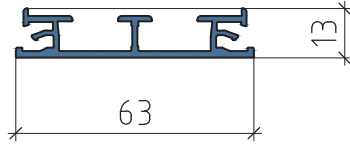

Mittelpartieprofil
Battues

291893



Glasleiste
Liste à verre

291869

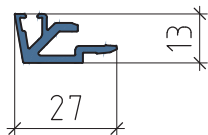

Aluminium Profilübersicht, schräg Gamme de profilés aluminium, en biais

Adapterprofil Profilé d'adaptation

291900 (roh)

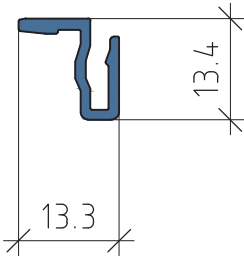

291901

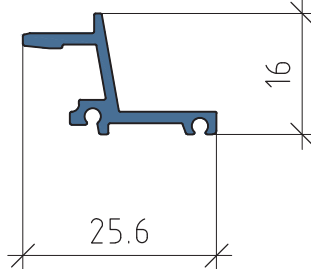

Anschlussprofil Profilé de connexion

291902

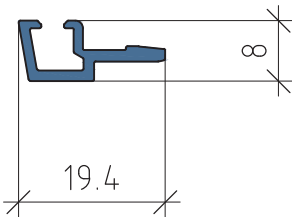

Nullschwelle Seuil

291892

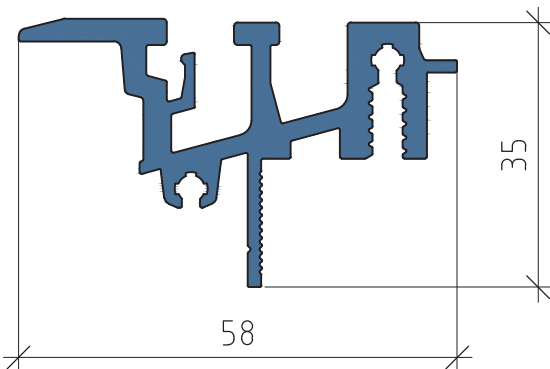

Aufnahmeprofil Profilé de réception

291891

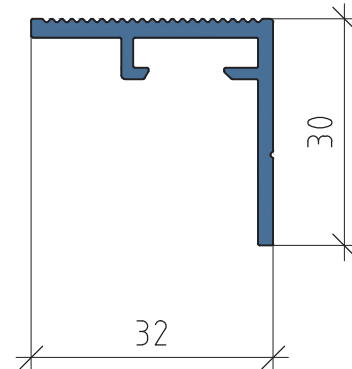

Kunststoff Profilübersicht

Gamme de profilés composite

Glasleiste Integralfenster
Liste à verre, système intégral

291897

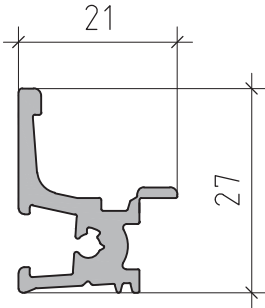

Dichtungsprofile Joints

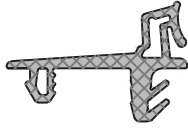

043186
Mitteldichtung
Joint médian
geschweisste Rahmen
cadre soudé

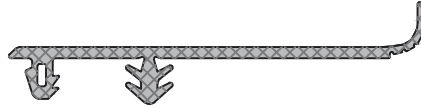

043187
Falzgrunddichtung
Joint médian
VE = 50 lfm



043188
Verglasungsdichtung aussen, vulkanisiert
Joint de vitrage extérieur, vulcanisé



043189
Dichtung zu Kunststoffprofil
Joint pour profilé composite
VE = 250 lfm



043190
Anschlagdichtung aussen
Joint d'appui extérieur
VE = 50 lfm

nicht lagerhaltig



043191
Verglasungsdichtung innen, verschr. Flügel
Joint de vitrage intérieur, ouvrant vissé
VE = 200 lfm

nicht lagerhaltig



043192
Falzgrunddichtung
Joint médian
VE = 50 lfm

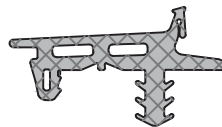

043193
Mitteldichtung (Integralflügel, SK)
Joint médian (ouvrant intégral, arête vive)
geschweisste Rahmen
cadre soudé

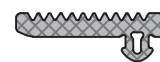

043194
Dichtung zu Hebeschiebetür (HST)
Joint pour porte levante coulissante
VE = 200 lfm

Dichtungsprofile

Joints

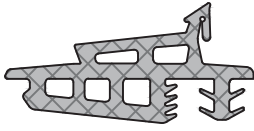

043196
 Mitteldichtung (klemmbare Klipse)
 Joint médian
 geschweisste Rahmen
 cadre soudé



043197
 Dichtungsprofil für Nullschwelle
 Joint pour seuil
 VE = 100 lfm

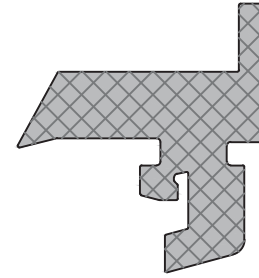

043198
 Dichtungsprofil für Nullschwelle
 Joint pour seuil
 VE = 25 lfm



043199
 Dichtungsprofil für Nullschwelle
 Joint pour seuil
 VE = 25 lfm

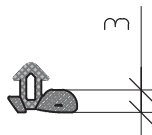

043200
 Vergl. Dichtung aussen 3mm
 Joint extérieur 3mm
 VE = 250 lfm

Zubehör Accessoires

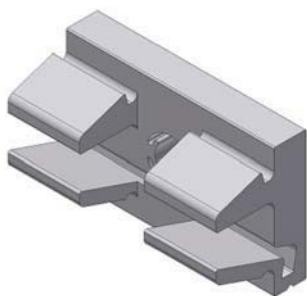

240721
Klipsverbinder, geschraubt
Clips à visser
VE = 1000 Stk

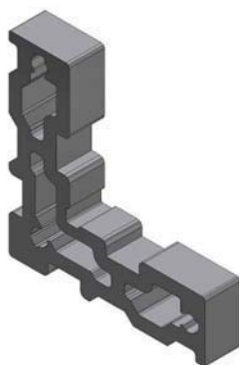

240722
Eckwinkel Flügel 10,9mm
Équerre d'angle pour ouvrants 10,9mm
VE = 500 Stk

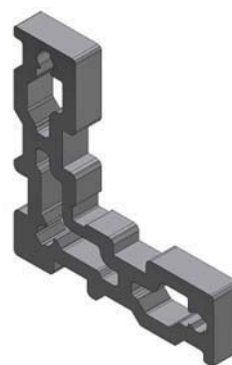

240723
Eckwinkel Rahmen 7,8mm
Équerre d'angle pour dormant 7,8mm
VE = 500 Stk



240724
Füllstück SK
Pièce de remplissage AV
VE = 200 Stk

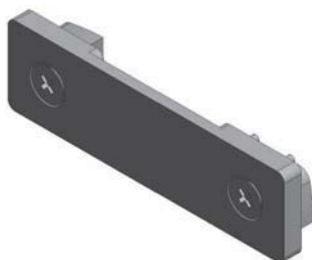

240725
T-Verbinder
T-connecteur
VE = 100 Stk



240726
Absturzsicherung
Protection antichute avec vis
VE = 500 Stk



240737
Drehverbinder
Bouton tournant
VE = 1000 Stk

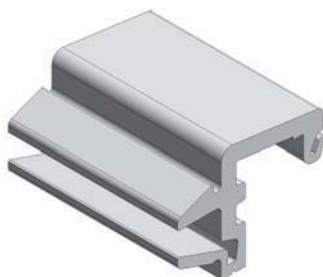

240738
Klipsverbinder klemmbar
Clip à coincer
VE = 1000 Stk

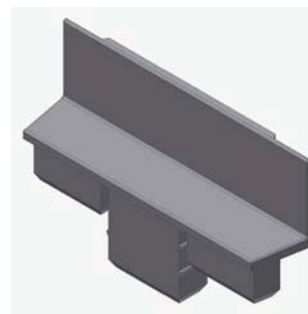

240739
Stulpkappe zu Mittelpartieprofil
Embout pour battues
VE = 100 Stk

Zubehör Accessoires



240413

Zusatzzeckwinkel
Équerre d'angle
VE = 500 Stk

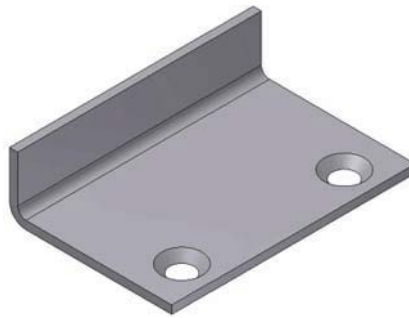

240509

Absturzsicherung inkl. Schraube
Protection antichute avec vis
VE = 50 Stk



240741

Stulpkappe zu Profil HA001584, schwarz
Embout pour profil HA001584, noir
VE = 100 Stk



240751

Seitenteil Nullschwelle
Embout droit de seuil
VE = 1 Stk



240758

Eckwinkel SK
Équerre d'angle AV
VE = 200 Stk



240764

Füllstück Schräg
Pièce de remplissage, en biais
VE = 200 Stk

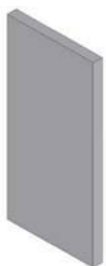

240766

Verbindungsplatte
Plaque de raccordement
VE = 200 Stk